

## Models

21000, 21001, 21004, 21005, 21006, 21009, 21010, 21011, 21014, 21015, 21016, 21019, 21020, 21021, 21024, 21025, 21026, 21029, 21030, 21031, 21034, 21035, 21036, 21039, 21040, 21041, 21044, 21045, 21046, 21049, 21050, 21051, 21054, 21055, 21056, 21059, 21060, 21061, 21062, 21063, 21064, 21065

**Note:** To order replacement parts specify the **Model #** and **Serial #** of your machine.

# Dynorbital-Spirit® Complete Assembly

## Index Key

No.	Part #	Description
1		Back-Up Pads - See Below
2		Non-Vacuum Shroud
	54458	3" & 3-1/2" Diameter
	56051	5" & 6" Diameter
3		Vacuum Shroud
	57084	3" & 3-1/2" Diameter
	69362	5" Diameter
	69363	6" Diameter
4	57069	Balancer Shaft
5	95630	Snap Ring
6	59084	V-Seal
7	56052	Bearing
8		Motor Shaft Balancer
		Orbit 3" 3-1/2" 5" 6"
	3/8"	59122 59070 59071 59072
	3/16"	59120 59060 59061 59062
	3/32"	59121 59065 59066 59067
9	56047	Key
10	59058	Lock Ring
11	59057	"Top Hat" Seal
12	59083	Felt
13	58368	Bearing (2)
14	59137	Front Bearing Plate
15	57113	Rotor/Blade Set
16	59134	Cylinder
17	95529	O-Ring
18	59133	Cylinder Sleeve Adapter
19	01024	O-Ring
20	59138	Rear Bearing Plate
21		Drop-In Motor Assembly (See Chart - Page 4)
22		Housing (See Chart - Page 4)
23		Throttle Lever
	69356	3/8" Dia. Orbit
	69360	3/16" Dia. Orbit
	69357	3/32" Dia. Orbit
24	94590	Pin
25	57041	Comfort Platform
26	98459	O-Ring
27	58363	Valve Stem
28	59075	Speed Regulator
29	01025	O-Ring (2)
30	95697	Retaining Ring
31	01464	Seal
32	58365	Tip Valve
33	01468	Spring
34	01494	Inlet Bushing
35	69364	Shroud Adapter
36	57083	Vacuum Adapter
37	96197	Dowel Pin
38	57066	Muffler Body
39	95526	O-Ring
40	59088	Vac Nozzle
41	57067	Vac Tube
42	57093	Vacuum Adapter
43	56027	Muffler Insert (AR)
44	69359	Muffler Cap

AR - As Required

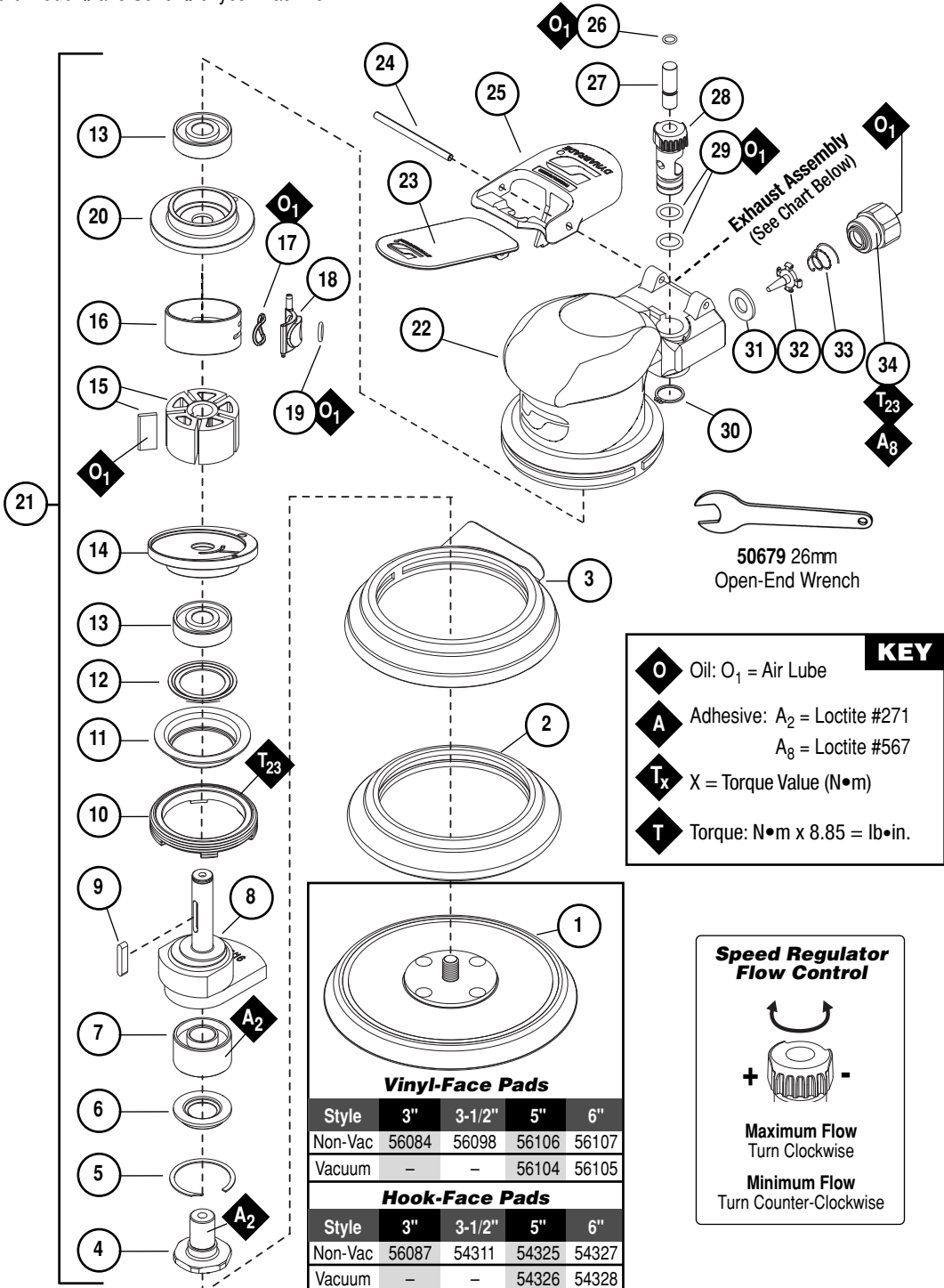

**Vinyl-Face Pads**

Style	3"	3-1/2"	5"	6"
Non-Vac	56084	56098	56106	56107
Vacuum	-	-	56104	56105

**Hook-Face Pads**

Style	3"	3-1/2"	5"	6"
Non-Vac	56087	54311	54325	54327
Vacuum	-	-	54326	54328

KEY	
<b>O</b>	Oil: O <sub>1</sub> = Air Lube
<b>A</b>	Adhesive: A <sub>2</sub> = Loctite #271 A <sub>8</sub> = Loctite #567
<b>T<sub>x</sub></b>	X = Torque Value (N•m)
<b>T</b>	Torque: N•m x 8.85 = lb•in.

