

SATAgraph™ 1/3/4

SATAgraph 1 - The Starter Model

	Technical Data	Inlet pressure: variable
		Air consumption: 10 NI/min
		Spray distance: variable



Nozzle	0,25	0,45
---------------	------	------

Each with aluminium case

134544	SATAgraph 1 0.25 with 2.5 ml gravity flow cup, in aluminium case, without hose	
139568	SATAgraph 1 0.25 with 5 ml suction cup, in aluminium case, without hose	
141408	SATAgraph 1 0.45 with 5 ml suction cup, in aluminium case, without hose	

Nozzle	0,25	0,45
---------------	------	------

Nozzle set

Art. No.	134619	134635	
-----------------	--------	--------	--

SATAgraph 3 - Premium Airbrush for Professionals

	Technical Data	Inlet pressure: variable
		Air consumption: 10 NI/min
		Spray distance: variable



Nozzle	0,15	0,25	0,45	0,65
---------------	------	------	------	------

Each with aluminium case

134551	SATAgraph 3 0.25 with 2.5 ml gravity flow cup, PVC air hose 3m with mini quick coupling and G 1/4" (female thread)	
134569	SATAgraph 3 0.25 with 2.5 ml gravity flow cup, in aluminium case, without hose	
134577	SATAgraph 3 0.25 with 5 ml siphon cup, PVC air hose 3 m with mini quick coupling and G 1/4" (female thread)	
134585	SATAgraph 3 0.25 with 5 ml siphon cup, in aluminium case, without hose	

Nozzle	0,15	0,25	0,45	0,65
---------------	------	------	------	------

Nozzle set

Art. No.	134643	134650	134668	134676	
-----------------	--------	--------	--------	--------	--

SATAgraph 4* - Universal airbrush gun

	Technical Data	Inlet pressure: variable
		Air consumption: 10 NI/min
		Spray distance: variable



Nozzle	0,5
---------------	-----

Each with aluminium case

227629	SATAgraph 4 nozzle 0.5 with 7 ml standard cup	
227637	SATAgraph 4 nozzle 0.5 with 7 ml side cup	
227645	SATAgraph 4 nozzle 0.5 with 6 ml suction cup	

Nozzle	0,5
---------------	-----

Nozzle set

Art. No.	227363	
-----------------	--------	--

* SATAgraph 4 is supplied without hoses and quick coupling nipple. These components have to be ordered separately (see spare parts)

All prices are recommended list prices. Errors, technical modifications and printing errors reserved. Air hoses for design spray guns see page 122.

Spare Parts SATAgraph™ 1/3/4

Art. No./Descr.

SATAgraph 1

32615	Coupling nipple (packing unit 3 pieces)
134767	2.5 ml gravity flow cup, cpl.
134775	5 ml gravity flow cup, cpl.
134783	5 ml suction cup, cpl.
134809	Trigger
138909	O-ring (packing unit 5 pieces)
142638	O-Ring (packing unit 5 pieces)

SATAgraph 3

32615	Coupling nipple (packing unit 3 pieces)
134767	2.5 ml gravity flow cup, cpl.
134775	5 ml gravity flow cup, cpl.
134783	5 ml suction cup, cpl.
134817	Needle cap
134833	Grip end piece
134957	Trigger
138909	O-ring (packing unit 5 pieces)
142638	O-Ring (packing unit 5 pieces)

SATAgraph 4

227108	Wrench for nozzle head
227116	O-Ring (packing unit 5 pieces)
227215	Trigger
227231	Handle end piece, complete
227249	Protection cap for paint needle
227256	23 ml glass cup, cpl.
227264	6 ml metal suction cup, cpl.
227272	7 ml metal side cup, cpl.
227280	Plug for material supply from the side, red
227306	Lid for metal paint cup, side cup and gravity flow cup version
227314	30 ml glass cup, cpl. with neutral lid
227322	30 ml glass cup, cpl.
227330	23 ml glass cup, cpl. with Fast Blast

Hoses and nipples

32615	Coupling nipple (packing unit 3 pieces)
32987	SATA PVC compressed air hose, transparent, 3 m long with G 1/4" (female thread), mini quick coupling and nipple
134791	SATA Fibre air hose, 2.5 m long with G 1/4" (female thread), mini quick coupling

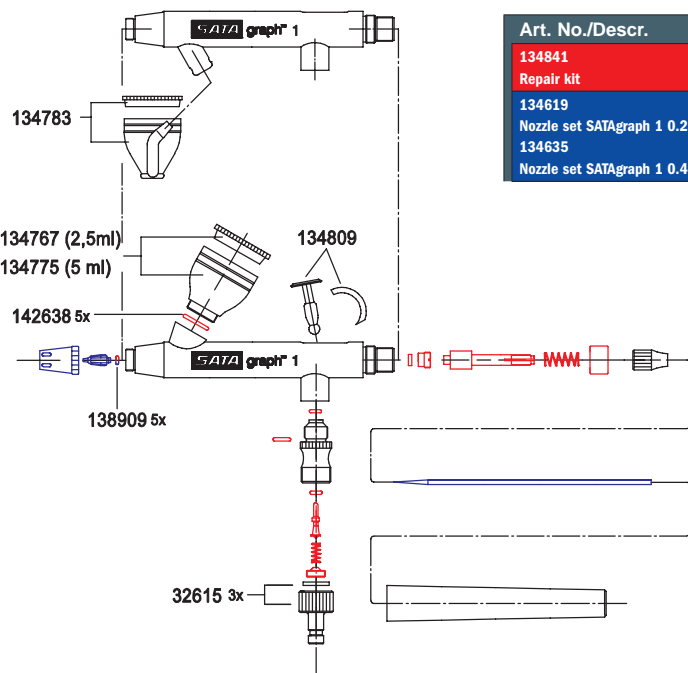

Art. No./Descr.

134841	Repair kit
134619	Nozzle set SATAgraph 1 0.25
134635	Nozzle set SATAgraph 1 0.45

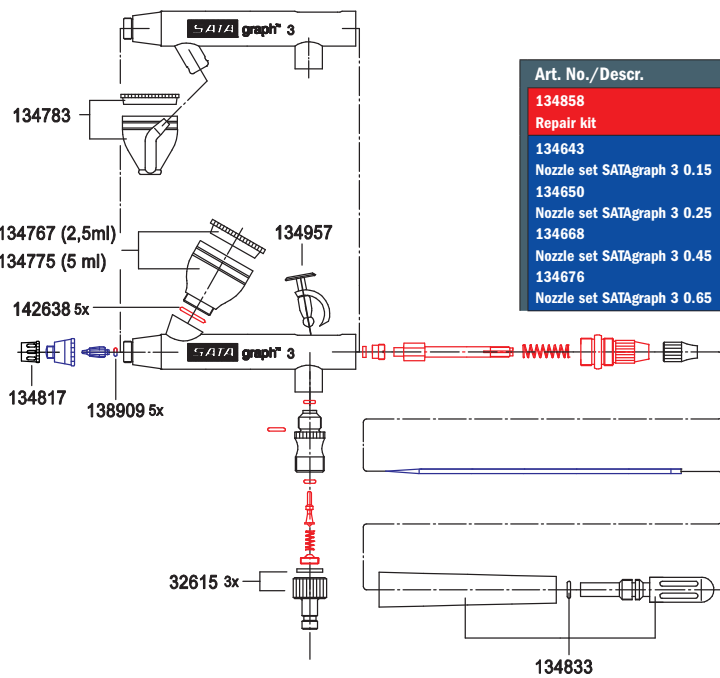

Art. No./Descr.

134858	Repair kit
134643	Nozzle set SATAgraph 3 0.15
134650	Nozzle set SATAgraph 3 0.25
134668	Nozzle set SATAgraph 3 0.45
134676	Nozzle set SATAgraph 3 0.65

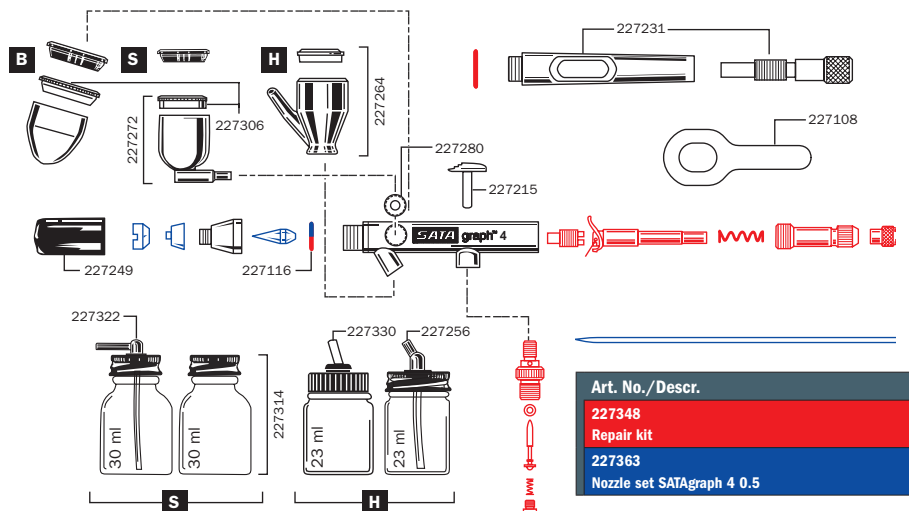

Art. No./Descr.

227348	Repair kit
227363	Nozzle set SATAgraph 4 0.5

All prices are recommended list prices. Errors, technical modifications and printing errors reserved.